

### OPERATING INSTRUCTIONS

1

Remove guidewire from the patient's catheter as per normal practice. Stabilise Venner WireSafe™ using index finger by covering the round magnet. Using other hand, insert the guidewire into the lightbulb shaped channel.

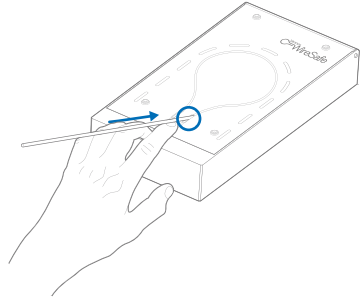

2

Push the guidewire through the channel until both ends of the guidewire are protruding outside of the channels.

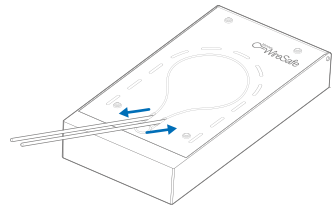

3

Move fingers from magnet onto the shelf at the front of the Venner WireSafe™. Whilst pushing down on the shelf with the fingers of one hand, hold the ends of the guidewire with the other hand and lift upwards to open the Venner WireSafe™.

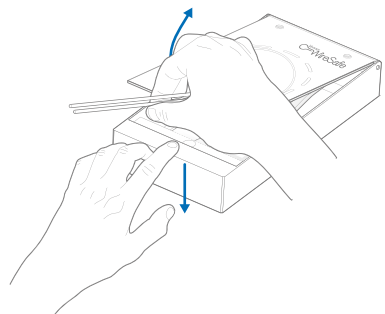

4

Use contents as per your normal practice to complete the procedure.

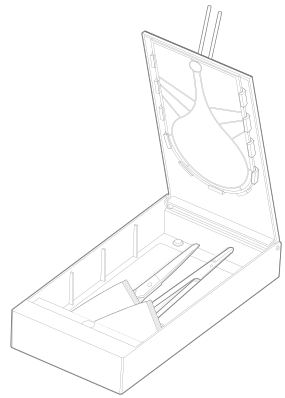

5

Dispose of Venner WireSafe™ in accordance with hospital policy.

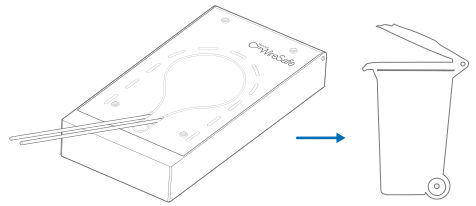

## TECHNICAL SPECIFICATIONS

### 0001 Product codes

200000 Venner WireSafe™ – Clear  
200100 Venner WireSafe™ – Blue

### Material

MABS

### Dimension

210L x 106W x 34.6H (mm)

### Capacity

480cm<sup>3</sup>

### Weight

160g (empty)



**Venner Medical Technologies SA**  
+44 (0)1534 872555  
info@venner.com  
www.vennermedical.com/venner-wiresafe

**Manufactured for:**  
Venner Medical (Singapore) Pte Ltd  
35 Joo Koon Circle,  
Singapore 629110

